

Inset 4B (Scale 1:2500)

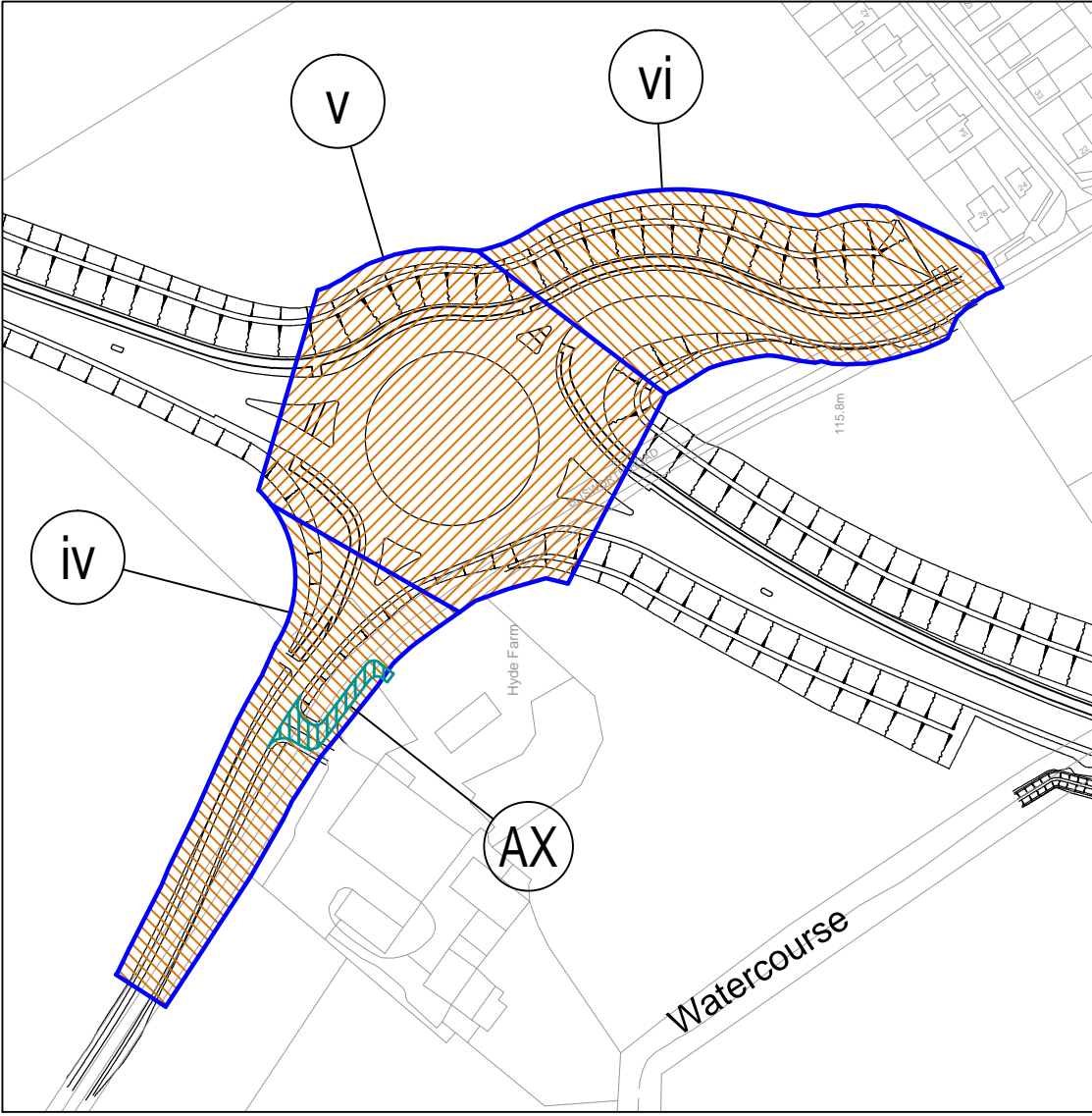

Inset 4C (Scale 1:2500)

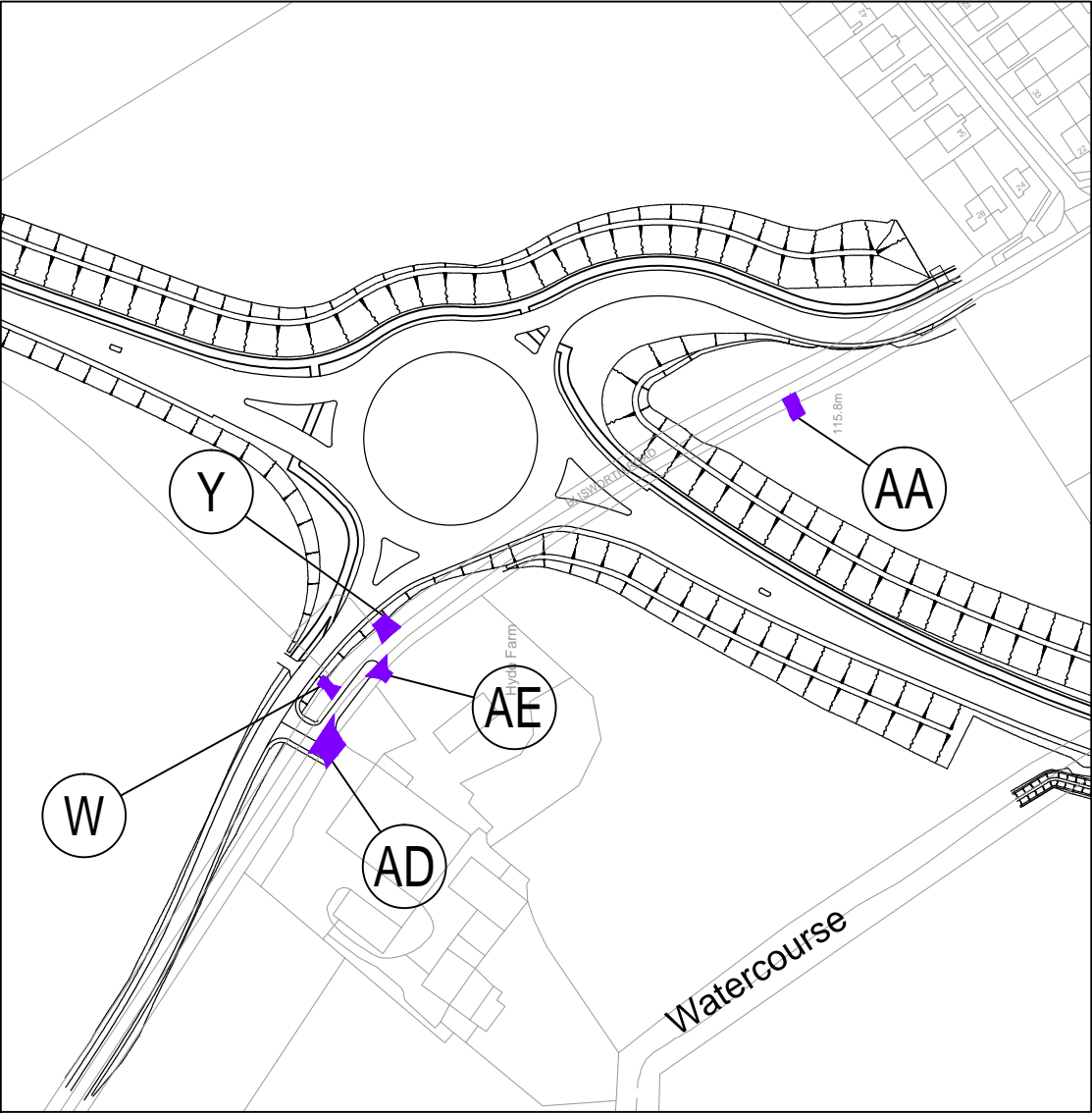

Inset 4D (Scale 1:2500)

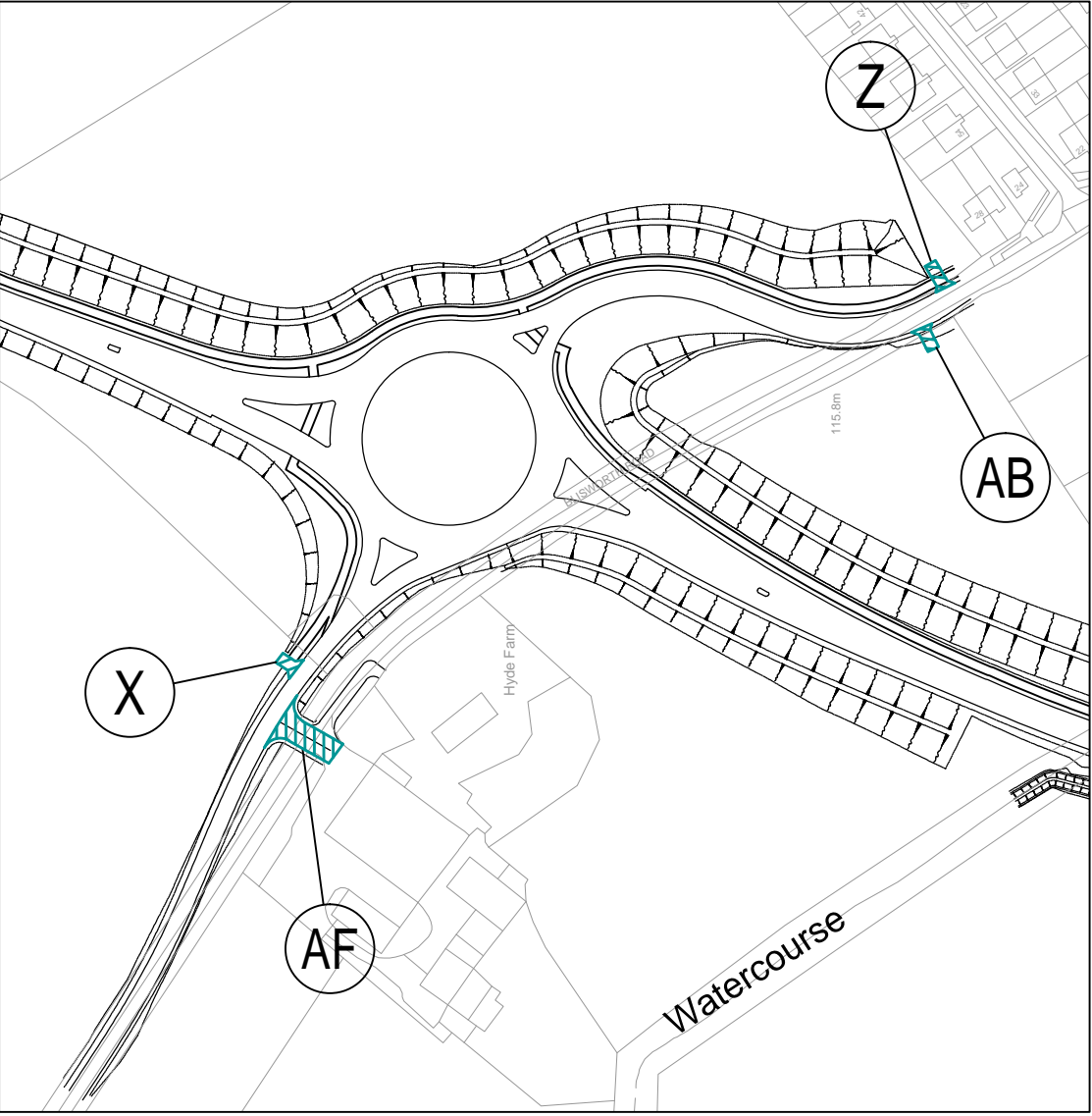

Inset 4A (Scale 1:2500)

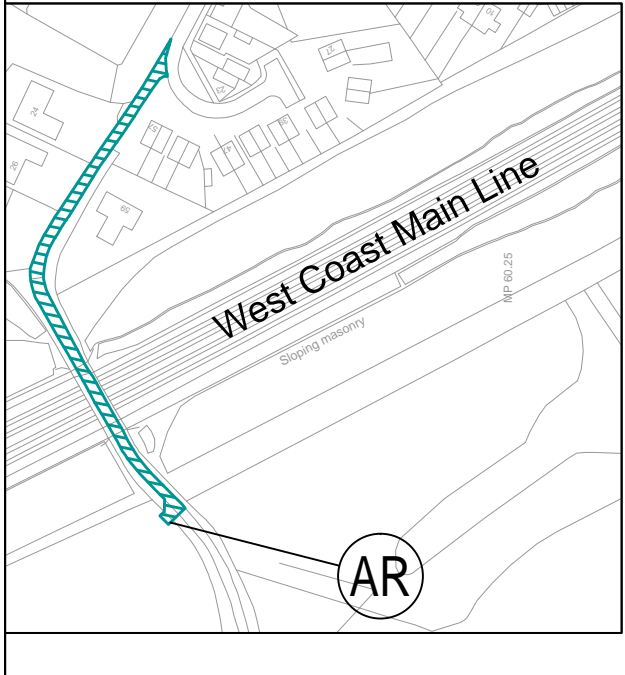

See also Inset 4A left

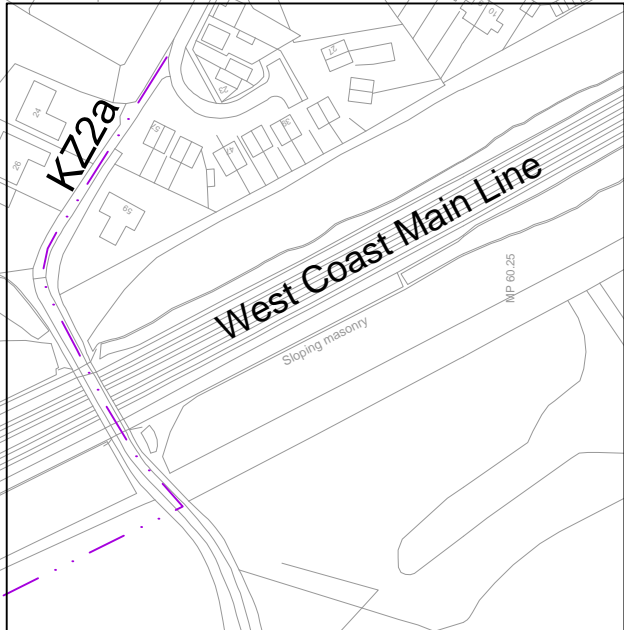

See also Insets 4B, 4C and 4D above

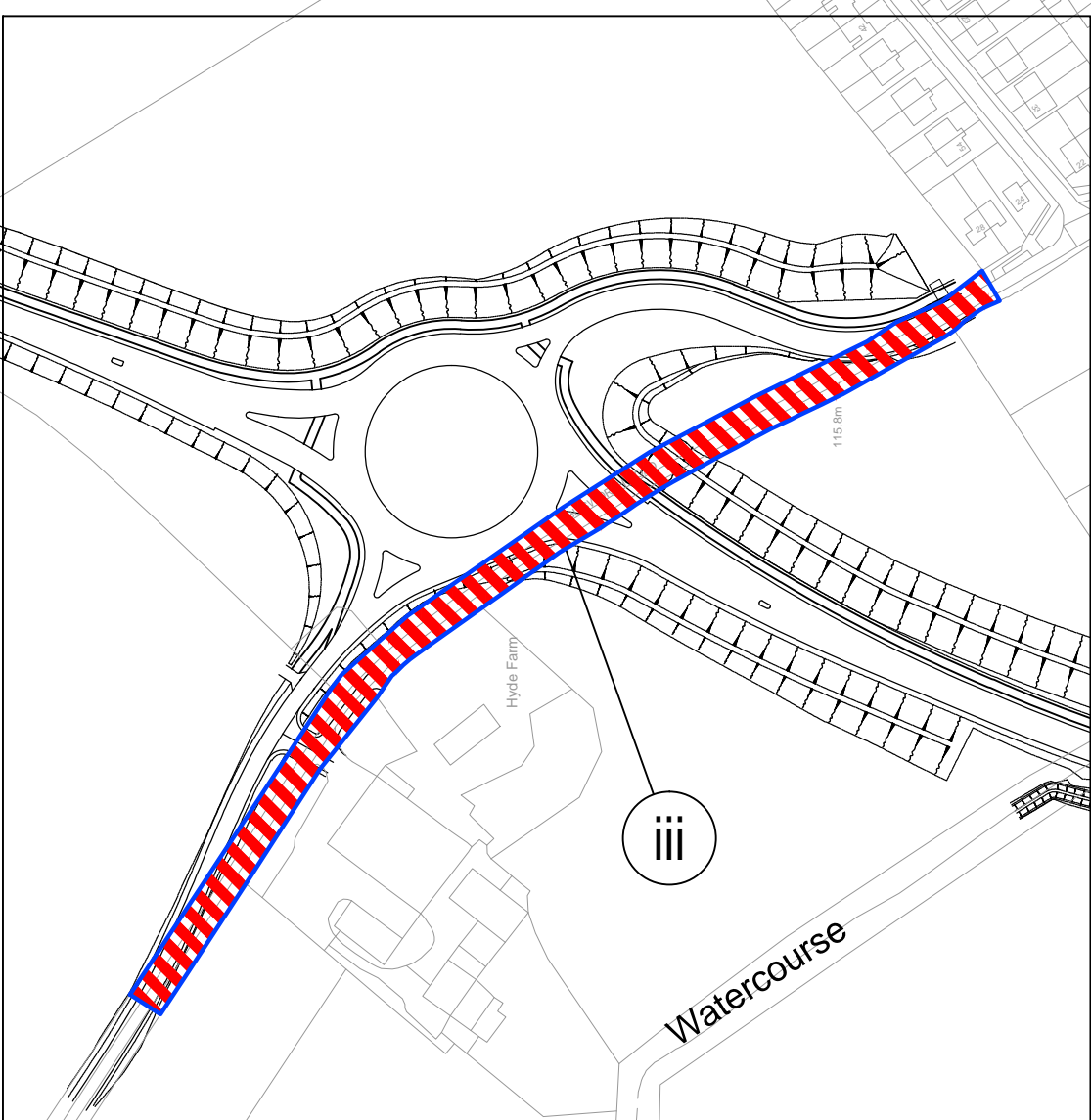

Legend

- EXISTING HIGHWAY TO BE STOPPED UP
- DIVERTED MOTORWAY SPECIAL ROAD
- DIVERTED ALL PURPOSE LOCAL HIGHWAY
- EXISTING PRIVATE MEANS OF ACCESS STOPPED UP
- NEW PRIVATE MEANS OF ACCESS
- EXISTING PUBLIC RIGHT OF WAY RETAINED
- EXISTING PUBLIC RIGHT OF WAY STOPPED UP
- NEW PUBLIC FOOTPATH CREATED
- NEW PUBLIC BRIDLEWAY CREATED
- NEW CYCLE TRACK CREATED (ALL PURPOSE HIGHWAY FOR USE BY PEDESTRIANS AND CYCLISTS ONLY)
- ROMAN NUMERAL REFERENCE LABELS: REFER TO SCHEDULE 4 OF THE DEVELOPMENT CONSENT ORDER
- NUMERIC REFERENCE LABELS: REFER TO SCHEDULE 5 OF THE DEVELOPMENT CONSENT ORDER
- ALPHABETIC REFERENCE LABELS: REFER TO SCHEDULE 6 OF THE DEVELOPMENT CONSENT ORDER
- ADMINISTRATIVE BOUNDARY BETWEEN SOUTH NORTHAMPTONSHIRE DISTRICT AND BOROUGH OF NORTHAMPTON

THE LEGEND IS IDENTICAL ON ALL SHEETS OF THE ACCESS AND RIGHTS OF WAY PLANS AND THEREFORE NOT ALL ITEMS DETAILED IN THE LEGEND ARE REPRESENTED ON EACH SHEET

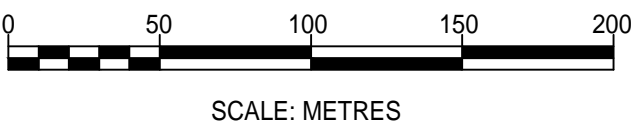

P7	10.01.19	Bridleway RZ1 Diversion Amended	PG	SRH
P6	22.10.18	Access ref AC removed		SRH
P5	24.04.18	Issued for Submission		SRH
P4	16.03.18	Scheme review		SRH
P3	28.02.18	Minor corrections		SRH
P2	26.01.18	Updates following Stage 2 consultation		GDJ
P1	27.09.17	Preliminary Issue		GDJ
Rev	Date	Details of issue / revision	Drw	Rev

ISSUES & REVISIONS

THE NORTHAMPTON GATEWAY RAIL FREIGHT INTERCHANGE ORDER 201X

ACCESS AND RIGHTS OF WAY PLANS SHEET 4 OF 5

Scale	1:2,500	Drawn	G. Jones
Size	A1	Reviewed	S. Hilditch
Regulation	5(2) (k)	Document	2.3D
Drawing Status	SUBMISSION		
Drawing No.	NGW-BWB-LSI-04-DR-C-00174	Revision	P7

Outline D - See Sheet 3 Document 2.3C

Outline E - See Sheet 5 Document 2.3E